

NZ PLUG POWER DISTRIBUTION UNITS, 10A/16A

DESCRIPTION

Unmanaged 6~20 Way Horizontal and Vertical 3-Pin 10Amp and 16Amp Power Distribution Units with 6KA C-Curve Circuit Breaker. This range incorporates a 10 & 16 Amp connector, ideal for connecting directly into UPS's to expand power port availability.

FEATURES

- 0/1/2RU, 6~20 Way Outlet Power Distribution Unit (PDU)
- Unmanaged full metal rack-mount PDU
- Built-in 6KA C-Curve circuit breaker
- Rated Voltage: 230V~/60Hz
- Horizontal PDU incorporates recessed brackets for cable management
- Vertical PDU incorporates three way mounting brackets for ease of installation

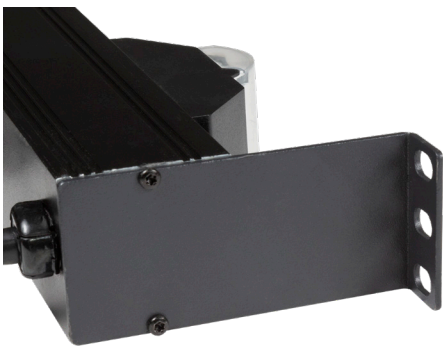

Horizontal PDU 50mm Recessed
Rackmount Bracket



6kA C-Curve Circuit Breaker



Vertical 3 Sided Mounting Bracket

MODEL CODE	DESCRIPTION	CABLE LENGTH	DIMENSIONS (WxHxD) O/A	INPUT CONNECTOR	RU
RPR-6HMCB	6 Outlet Horizontal Power Rail	2m	482.50 x 45 x 95mm	10A, 3-Pin	1
RPR-10HMCB	10 Outlet Horizontal Power Rail	2m	482.60 x 90 x 95mm	10A, 3-Pin	2
RPR-10VMCB	10 Outlet Vertical Power Rail	0.75m	752.50 x 50 x 67mm	10A, 3-Pin	0
RPR-15VMCB	15 Outlet Vertical Power Rail	1m	1040 x 50 x 67mm	10A, 3-Pin	0
RPR-20VMCB	20 Outlet Vertical Power Rail	1.3m	1327.50 x 50 x 67mm	10A, 3-Pin	0
RPR-10V15MCB	10 Outlet Vertical Power Rail	2m	752.50 x 50 x 67mm	16A, 3-Pin	0
RPR-20V15MCB	20 Outlet Vertical Power Rail	2m	1327.50 x 50 x 67mm	16A, 3-Pin	0

SPECIFICATIONS

Material	Steel
Operating Temperatures	-10°C~+40°C
Storage Temperature	-10°C~+60°C
Working Humidity	5% (0°C)~90% (40°C)
Voltage	230V~/60Hz
Colour	Black powdered coated

FULL RANGE

HORIZONTAL RACK MOUNTS



VERTICAL RACK MOUNTS

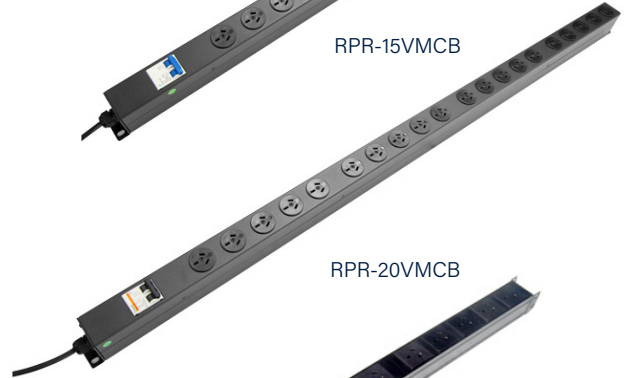

RPR-6HMCB: Front View

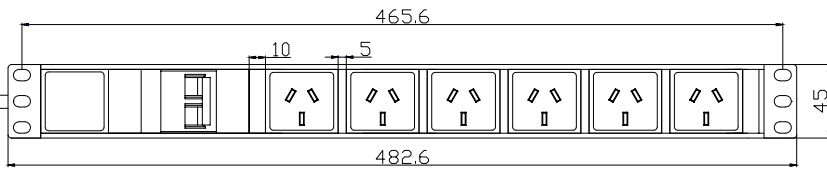

Top View of Horizontal Units Depth

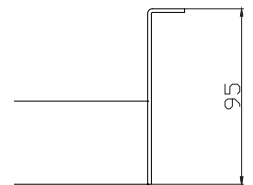

RPR-10HMCB: Front View

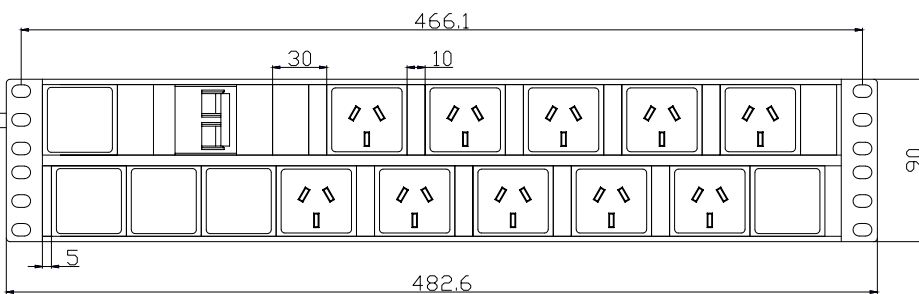

RPR-10VMCB: Front View

Top View of Vertical Units Depth

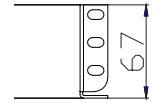
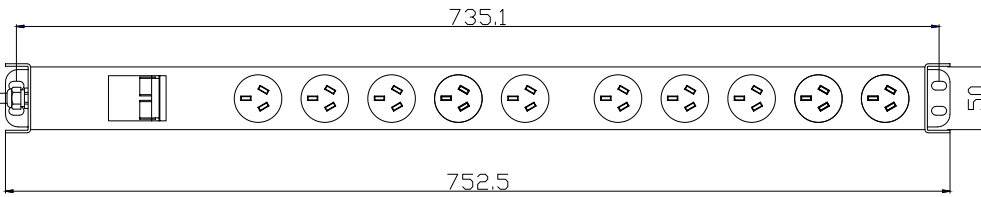

RPR-15VMCB: Front View

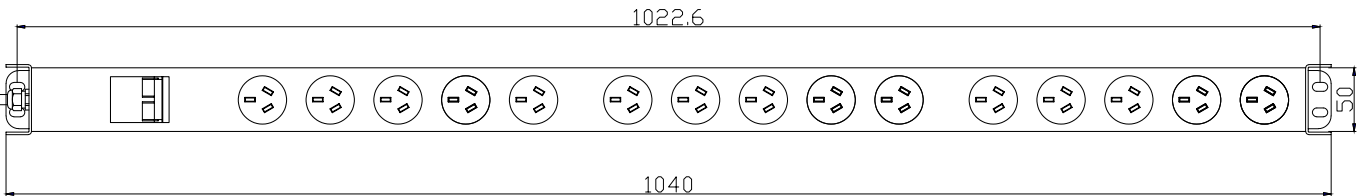

RPR-20VMCB: Front View

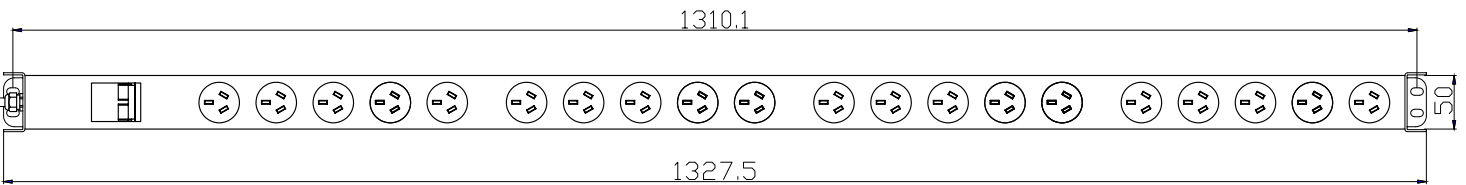

RPR-10V15MCB: Front View

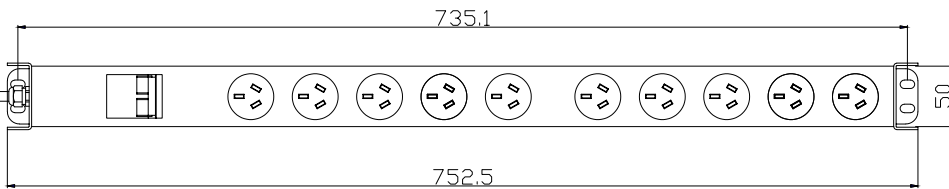

RPR-20V15MCB: Front View

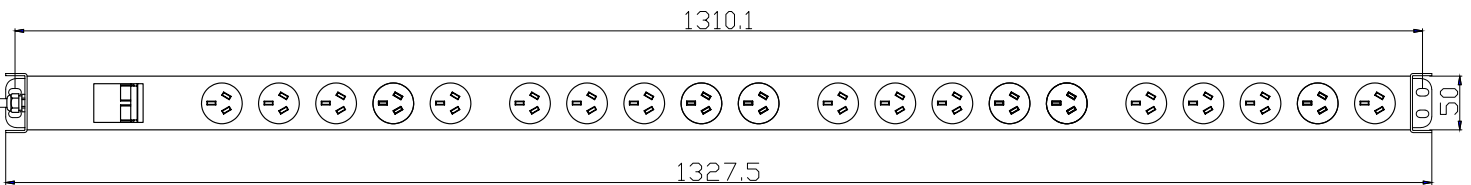

ALSO AVAILABLE:

 <p>RAPRB Vertical PDU Mounting Brackets (Sold as a pair)</p>	 <p>RAC0600 JACKSON 1RU 6x Outlet Horizontal Power Rail. Surge Protected 525J 10A Overload Protected.</p>	 <p>RAC1200 JACKSON 2RU 12x Outlet Horizontal Power Rail. Surge Protected 525J 10A Overload Protected</p>	 <p>RPSK-16A8 8 Port 16A kWh Switched PDU . Total Remote Power Monitoring & Outlet Control.</p>
---	---	--	---

Please note we took the up-most care to compile the information in this datasheet. To the best of our knowledge all info provided were correct at the time of creation. Should any specs change we try to update info accordingly. Information are subject to change without notice. In the case that you find any irregularity please inform our team at contactus@dynamix.co.nz

Last updated: 11 September 2019